

PT. OF THE E¹/₂ OF SECTION 7, T34N, R5W,
CITY OF PETOSKEY, EMMET CO., MI

Proposed Site Plan

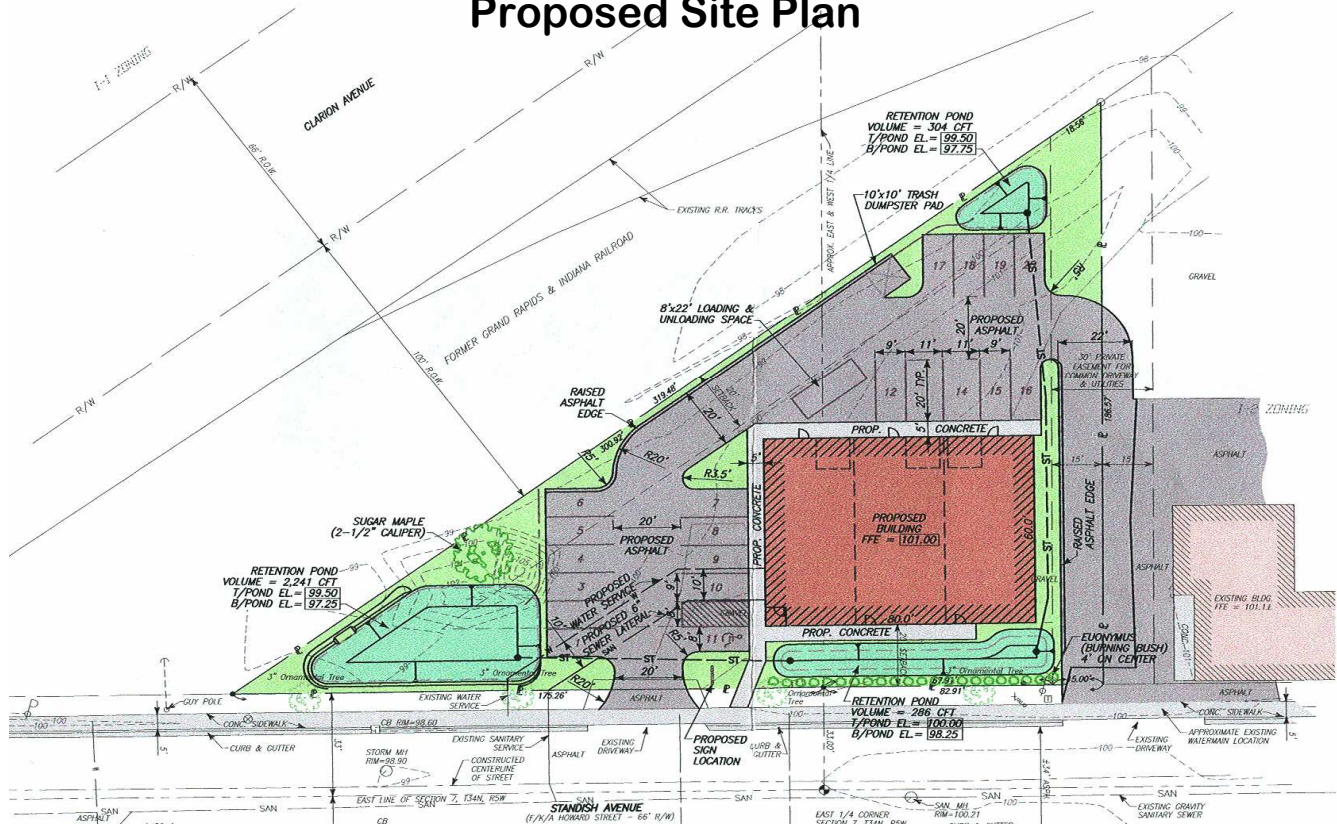

Offered by: Jack VanTreese & Associates (231) 347-3943

MLS# 416740		Address: 1700 Standish Ave		City: Petoskey		Price: \$79,000																														
Owner: Waterman																																				
Legal: Part of S.E. 1/4 of N.E. 1/4 & Part of N.E. 1/4 of S.E. Sec 7, T34N, R5W																																				
<table border="1"> <tr><td>Possession</td><td>at close</td></tr> <tr><td>Terms</td><td>Cash / Conventional</td></tr> <tr><td>Lot Size</td><td>319 x 258 x 186</td></tr> <tr><td>Acres</td><td>0.55</td></tr> <tr><td>Zoning</td><td>I-2</td></tr> <tr><td>Improvements</td><td>Approved for</td></tr> <tr><td></td><td>4800 sq ft bldg</td></tr> <tr><td>Road Access</td><td>Public - Paved</td></tr> <tr><td>SEV</td><td>N/A</td></tr> <tr><td>Electric</td><td>City of Petoskey</td></tr> <tr><td>Water/ Sewer</td><td>City of Petoskey</td></tr> <tr><td>Parking</td><td>off street</td></tr> <tr><td>Township</td><td>City of Petoskey</td></tr> <tr><td>Directions</td><td>Corner of Howard Rd & Bear River Rd</td></tr> <tr><td>County</td><td>Emmet</td></tr> </table>	Possession	at close	Terms	Cash / Conventional	Lot Size	319 x 258 x 186	Acres	0.55	Zoning	I-2	Improvements	Approved for		4800 sq ft bldg	Road Access	Public - Paved	SEV	N/A	Electric	City of Petoskey	Water/ Sewer	City of Petoskey	Parking	off street	Township	City of Petoskey	Directions	Corner of Howard Rd & Bear River Rd	County	Emmet	REMARKS:					
	Possession	at close																																		
	Terms	Cash / Conventional																																		
	Lot Size	319 x 258 x 186																																		
	Acres	0.55																																		
	Zoning	I-2																																		
	Improvements	Approved for																																		
		4800 sq ft bldg																																		
	Road Access	Public - Paved																																		
	SEV	N/A																																		
	Electric	City of Petoskey																																		
	Water/ Sewer	City of Petoskey																																		
	Parking	off street																																		
	Township	City of Petoskey																																		
	Directions	Corner of Howard Rd & Bear River Rd																																		
County	Emmet																																			
		Commercial lot on Standish Avenue offers easy access to downtown and main highways. This site has already been approved to build a 4800 square ft. building with 20 parking spaces.																																		
		Owner will sell the lot "as is" for \$ 79,000!																																		
		Perfect location for furniture and appliance, household equipment, repair shops, decorator, electrician or similar trade business.																																		
		Information is believed to be accurate but is not warranted																																		
		Agent : Jack VanTreese (231) 347-3943																																		